

Variolink® Esthetic LC

Placement of inlays (thickness < 2 mm) (glass-ceramic, e.g. IPS e.max®)

Try-in

Variolink Esthetic Try-In

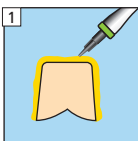

Application of Try-in paste

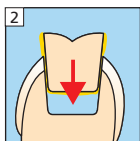

Try-in of restoration

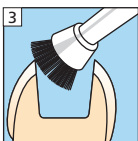

Cleaning after try-in

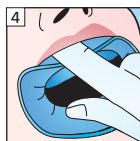

Isolation

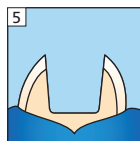

Restoration

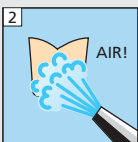
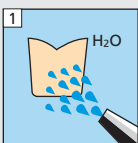

Monobond Etch & Prime

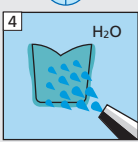
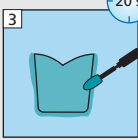

Preparation

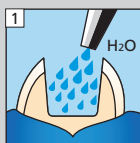

Total Etch optional

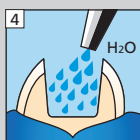
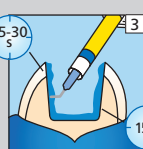

Adhese Universal

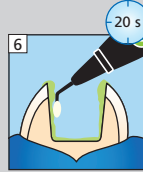

Avoid pooling



Bluephase Style

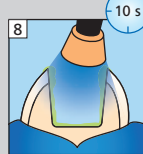

Cementation

Variolink Esthetic LC

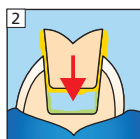
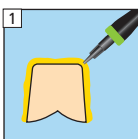

Bluephase Style

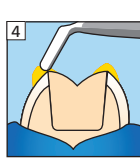

Secure the restoration until final polymerisation

Liquid Strip

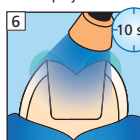
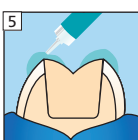

* per segment and mm ceramic

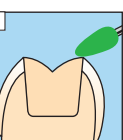

Polishing

Fluor Protector

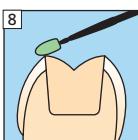

more information
www.cementation-navigation.com

CE 0123



Please read
Instruction for Use

ivoclar
vivadent
clinical

Date information prepared: 2015-07-13
681584/EN/Rev.0

Variolink® Esthetic LC

Placement of veneers (glass-ceramic, e.g. IPS e.max®)

Try-in

Variolink Esthetic Try-In

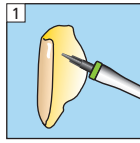

Application of Try-in paste

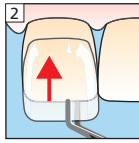

Try-in of restoration

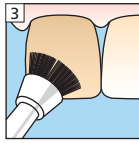

Cleaning after try-in

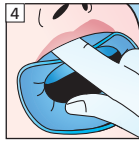

Isolation

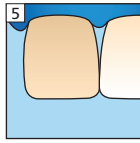

Restoration

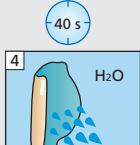
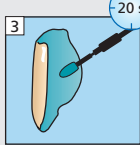
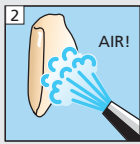
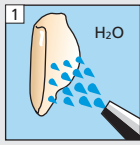

Monobond Etch & Prime



Preparation

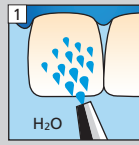

Total Etch optional

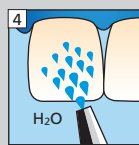
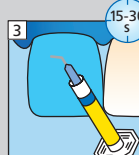

Adhese Universal

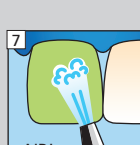
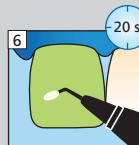

Bluephase Style

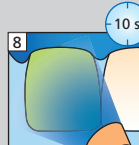

Cementation

Variolink Esthetic LC

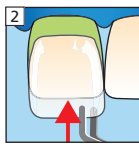
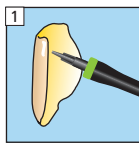

Bluephase Style

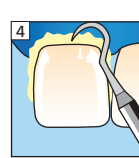

Liquid Strip

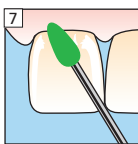
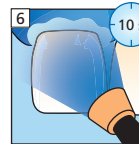
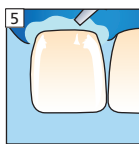

Fluor Protector

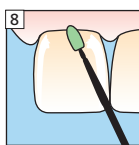

more information
www.cementation-navigation.com

CE 0123



Please read
Instruction for Use

ivoclar
vivadent
clinical