

Variolink® Esthetic DC

Placement of inlays (glass ceramic, composite)

Try-in

Variolink Esthetic Try-in

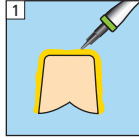

Application of Try-in paste

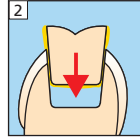

Try-in of restoration

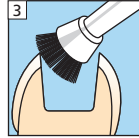

Cleaning after Try-in

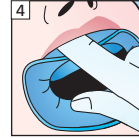

Isolation

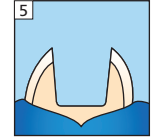

Restoration

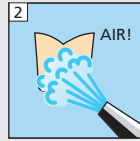
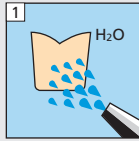

Pre-treatment of ceramic restorations:
According to manufacturer's instructions
E.g. IPS Empress: Etch for 60 s
IPS e.max CAD/Press: Etch for 20 s
with IPS Ceramic etching gel (hydrofluoric acid). Follow safety instructions.

Pre-treatment of composite restorations:
According to manufacturer's instructions
E.g. SR Nexco, 2 bar, Al₂O₃ 100 µm
or roughened with finishing diamonds.

Monobond Plus

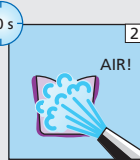
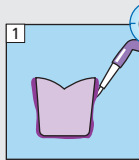

Total Etch
optional

Preparation

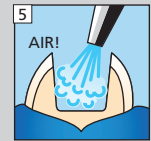
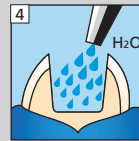
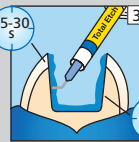
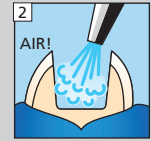
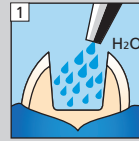

Adhese Universal

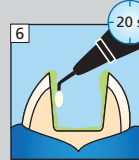

Avoid pooling

Bluephase Style

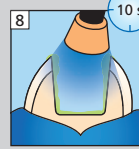

Cementation

Variolink Esthetic DC

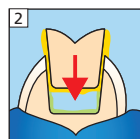
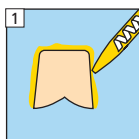

Bluephase Style

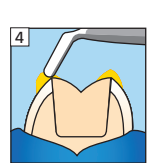
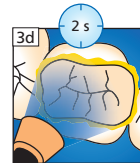
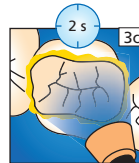
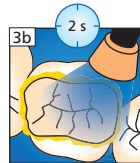
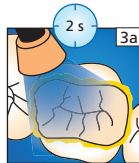

Secure the restoration until final polymerisation

Liquid Strip

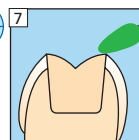
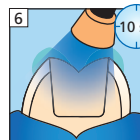
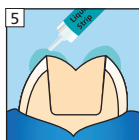

* per segment and mm ceramic

Polishing

Fluor Protector

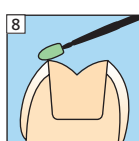

more information
www.cementation-navigation.com

CE 0123



Please read
Instruction for Use

ivoclar
vivadent
clinical

Date information prepared: 2014-06-25
666357/e/Rev. 0

Variolink® Esthetic DC

Placement of crowns and bridges
(glass ceramic, oxide ceramic, composite)

Try-in

Variolink Esthetic Try-in

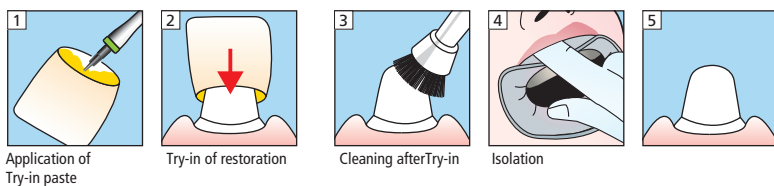

Restoration

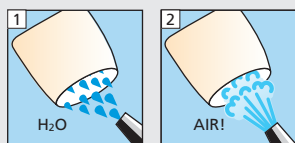

Pre-treatment of glass ceramic restorations:
According to manufacturer's instructions
E.g. IPS Empress: Etch for 60 s
IPS e.max CAD/Press: Etch for 20 s
with IPS Ceramic etching gel (hydrofluoric acid). Follow safety instructions.

Pre-treatment of oxide ceramic restorations:
According to manufacturer's instructions
E.g. IPS e.max ZirCAD
max. 1 bar, Al₂O₃ 100 µm

Pre-treatment of composite restorations:
According to manufacturer's instructions
E.g. SR Nexco, 2 bar, Al₂O₃ 100 µm
or roughened with finishing diamonds.

Monobond Plus

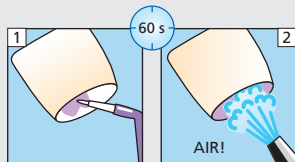

Total Etch
optional

Preparation

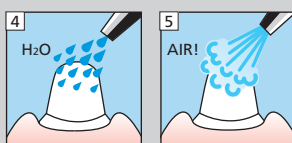
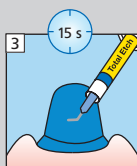
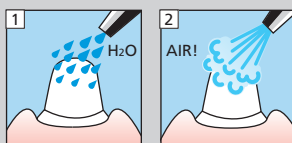

Adhese Universal

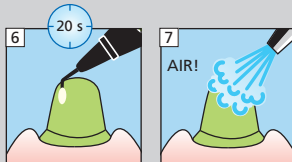

Avoid pooling

Bluephase Style

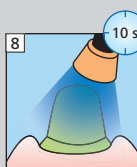

Cementation

Variolink Esthetic DC

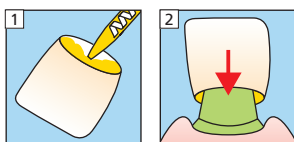

Bluephase Style

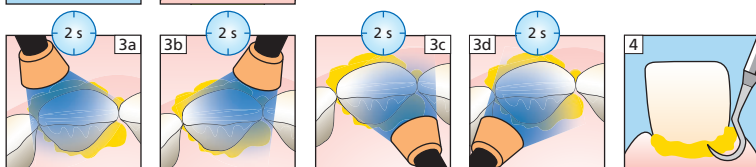

Secure the restoration until final polymerisation

Liquid Strip

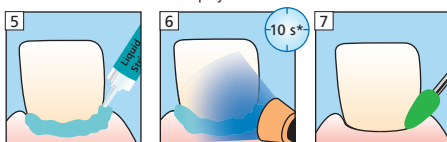

* per segment and mm ceramic

Fluor Protector

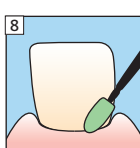

more information
www.cementation-navigation.com

CE 0123



Please read
Instruction for Use

ivoclar
vivadent
clinical